

Notice of Making

THE FLINTSHIRE COUNTY COUNCIL

**A548 CHESTER STREET, A548 CHESTER ROAD, A548 HOLYWELL STREET, A548
TRELAWNY SQUARE, EVANS STREET, DUKE STREET, PARK AVENUE, CASTLE DYKE
STREET, MARSH LANE, ST MARYS WALK, BARONS CLOSE, BOROUGH GROVE,
TRELAWNY AVENUE, LOWER SYDNEY STREET, CHURCH STREET, EARL STREET, LOWER
MUMFORTH STREET, CORPORATION STREET, SALUSBURY STREET, CASTLE STREET,
SYDNEY STREET, FEATHER STREET, QUEEN STREET AND MARKET SQUARE / Y
FARCHNAD FLINT.**

PROHIBITION OF WAITING, PROHIBITION OF WAITING AT ANY TIME AND LIMITED WAITING.

Notice is hereby given that on the 2nd June 2020, Flintshire County Council made an Order in exercise of its powers under the Road Traffic Regulation Act 1984, the Traffic Management Act 2004, Part IV of Schedule 9 and all other enabling powers, the effect of which will be to amend The Flintshire County Council (Prohibition and Restriction of Waiting and Loading and Parking Places) (Civil Enforcement and Consolidation) Order 2013 so as to introduce:

(a) No Waiting At Any Time restrictions -:

- 1) At various locations on both sides of the A548 Chester Street.
- 2) At various locations on both sides of the A548 Chester Road.
- 3) At various locations on both sides of the A548 Holywell Street.
- 4) At various locations on both sides of the A548 Trelawny Square
- 5) At various locations on both sides of the Market Square / Y Farchnad.
- 6) On the north westerly side of Lower Sydney Street
- 7) At various locations on both sides of St Marys Walk.
- 8) At various locations on both sides of Church Street.
- 9) At various locations on both sides of Evans Street.
- 10) At various locations on both sides of Earl Street.
- 11) On the north westerly side of Lower Mumfirth Street.
- 12) At various locations on both sides of Corporation Street.
- 13) At various locations on both sides of Castle Dyke Street.
- 14) On both sides of the traffic island fronting Numbers 2 – 28 Chester Street.
- 15) At various locations on both sides of the road adjacent to the Town Hall and The Ship Public House (also known as Market Square / Y Farchnad).
- 16) At the junction of the road adjacent to the Town Hall and The Ship Public House (also known as Market Square / Y Farchnad) with the A548.
- 17) At the junction of Market Square / Y Farchnad with Evans Street.
- 18) At the junction of Castle Dyke Street with Marsh Lane.
- 19) At the junction of Church Street with the A548.
- 20) At the junction of Earl Street with the A548.
- 21) At the junction of Market Square / Y Farchnad with the A548.
- 22) At the junction of Salusbury Street with Corporation Street.
- 23) At the junction of Castle Street with Corporation Street.
- 24) At the junction of Lower Sydney Street with the A548.
- 25) At the junction of Lower Mumfirth Street with the A548
- 26) At the junction of Sydney Street with the A548
- 27) At the junction of Duke Street with the A548.
- 28) At the junction of Park Avenue with the A548.
- 29) At the junction of Borough Grove with the A548.
- 30) At the junction of Trelawny Avenue with the A548.
- 31) At the junction of Marsh Lane with Castle Dyke Road
- 32) At the junction of Numbers 55 - 57 Chester Road with the A548.
- 33) At the entrance to the car park adjacent to Number 38 Chester Road.

- 34) At the junction of Queen Street with the A548.
- 35) At the junction of Number 31 Chester Road with the A548.
- 36) At the junction of Princes Street with the A548.
- 37) On the South West side of Barons Close.
- 38) At the junction of Castle Dyke Street with the Lifeboat Station Car Park.
- 39) On both sides of the Earl Street junction with the Service Road leading to Flint Retail Park Centre.(Including the mini roundabout)
- 40) On both sides of the Service Road leading to Flint Retail Park Centre junction with the Jade Jones Pavilion Centre Leisure Car parks.
- 41) On both sides of the Service Road junction adjacent to Number 28 and Number 34 Chester Street.

(b) No Waiting restrictions between 8am – 6pm -:

- 1) At various locations on both sides of the A548 Chester Road.
- 2) On the South East side of Borough Grove.
- 3) On the South West side of Chapel Street.
- 4) On the North East side of the Service road at the rear of Numbers 2 – 28 Chester Street

(c) Limited Waiting restrictions 30 minutes No Return 1 Hour between 8am – 6pm -:

- 1) At various locations on the North West side of Church Street.
- 2) At various locations on both sides of Market Square / Y Farchnad.
- 3) On the north east side of the A548 Chester Street
- 4) On the South West side of the Service Road fronting Numbers 6 to 28 on the A548 Chester Street.

Following the statutory consultation, the waiting restrictions have been omitted from the eastern side of both Lower Sydney Street and Lower Mumfirth Street, except within its junction with the A548.

In all other respects the present provisions of the 'The Flintshire County Council (Prohibition and Restriction of Waiting and Loading and Parking Places) (Civil Enforcement and Consolidation) Order 2013' will remain in force.

The Order revokes The Flintshire County Council (Church Street, Flint) (Mandatory Cycle Lane) Order 2004 in its entirety.

In the interests of safety during the COVID-19 Pandemic, should you wish to view a copy of this Notice, the Order which will come into operation on the 29th June 2020, plans showing the roads affected by the Order and a statement of the Council's reasons for the making of the Order, it is advisable that you view them on our website at www.Flintshire.gov.uk > Resident > Roads, Streets and Travel > Traffic Regulation Orders. Alternatively, you can request a copy of the documents by emailing Streetscene@flintshire.gov.uk. They may also be viewed in the windows of the Flintshire County Council Offices, Chapel Street, Flint CH6 5BD and Flintshire County Council, Alltami Depot, Mold Road, Alltami, Flintshire CH7 6LG.

If you wish to question the validity of the Order or any of its provisions on the grounds that any requirements of the Act or any instruments made under it has not been complied with, you may, within 6 weeks from the date on which the Order is made, apply for the purpose to the High Court.



Stephen O Jones, Chief Officer (Streetscene and Transportation), County Hall, Mold, Flintshire. CH7 6NR. 5th June 2020.

THE FLINTSHIRE COUNTY COUNCIL

**A548 CHESTER STREET, A548 CHESTER ROAD, A548
HOLYWELL STREET, A548 TRELAWNY SQUARE, EVANS
STREET, DUKE STREET, PARK AVENUE, CASTLE DYKE
STREET, MARSH LANE, ST MARYS WALK, BARONS CLOSE,
BOROUGH GROVE, TRELAWNY AVENUE, LOWER SYDNEY
STREET, CHURCH STREET, EARL STREET, LOWER MUMFORTH
STREET, CORPORATION STREET, SALUSBURY STREET,
CASTLE STREET, SYDNEY STREET, FEATHER STREET, QUEEN
STREET AND MARKET SQUARE / Y FARCHNAD, FLINT.
(PROHIBITION AND RESTRICTION OF WAITING
AND LOADING AND PARKING PLACES)
(CIVIL ENFORCEMENT AND CONSOLIDATION) (AMENDMENT
NO. 39) ORDER 2020**

**Stephen O Jones,
Chief Officer (Streetscene & Transportation),
County Hall,
Mold,
Flintshire,
CH7 6NF**

THE FLINTSHIRE COUNTY COUNCIL

**A548 CHESTER STREET, A548 CHESTER ROAD, A548 HOLYWELL STREET, A548
TRELAWNY SQUARE, EVANS STREET, DUKE STREET, PARK AVENUE, CASTLE
DYKE STREET, MARSH LANE, ST MARYS WALK, BARONS CLOSE, BOROUGH
GROVE, TRELAWNY AVENUE, LOWER SYDNEY STREET, CHURCH STREET, EARL
STREET, LOWER MUMFORTH STREET, CORPORATION STREET, SALUSBURY
STREET, CASTLE STREET, SYDNEY STREET, FEATHER STREET, QUEEN STREET
AND MARKET SQUARE / Y FARCHNAD, FLINT**

(PROHIBITION AND RESTRICTION OF WAITING

AND LOADING AND PARKING PLACES)

(CIVIL ENFORCEMENT AND CONSOLIDATION) (AMENDMENT NO. 39) ORDER 2020

Flintshire County Council in exercise of its powers under sections 1 (1), 2 (1)(2), 4 (2)(3) and Part IV of Schedule 9 of the Road Traffic Regulation Act 1984 ("the Act of 1984") as amended, the Traffic Management Act 2004 ("the 2004 Act") and of all other enabling powers and after consultation with the Chief Officer of Police in accordance with Part III of Schedule 9 to the Act of 1984, hereby makes the following Order:-

SECTION 1 – PRELIMINARY

Citation and commencement

1. This Order shall come into operation on the 29th June 2020 and may be cited as The Flintshire County Council A548 CHESTER STREET, A548 CHESTER ROAD, A548 HOLYWELL STREET, A548 TRELAWNY SQUARE, EVANS STREET, DUKE STREET, PARK AVENUE, CASTLE DYKE STREET, MARSH LANE, ST MARYS WALK, BARONS CLOSE, BOROUGH GROVE, TRELAWNY AVENUE, LOWER SYDNEY STREET, CHURCH STREET, EARL STREET, LOWER MUMFORTH STREET, CORPORATION STREET, SALUSBURY STREET, CASTLE STREET, SYDNEY STREET, FEATHER STREET, QUEEN STREET AND MARKET SQUARE / Y FARCHNAD, FLINT (Prohibition and Restriction of Waiting and Loading and Parking Places) (Civil Enforcement and Consolidation) (Amendment No. 39) Order 2020
2. With effect from the date set out in Article 1 above, Map Schedules AL58 and AL59, Sheet Revision No: 4, replaces Map Schedule AL58 and AL59 Sheet Revision No: 3 and Map Schedule AL57 Sheet Revision No: 3, replaces Map Schedule AL57 Sheet

Revision No: 2 and Map Schedule AM59 and AK58 Sheet Revision No: 2, replaces Map Schedule AM59 Sheet Revision No: 1, respectively and all other map schedules together with the before mentioned map schedules and plans referred to in the Schedules to this Order are incorporated into The Flintshire County Council (Prohibition and Restriction of Waiting and Loading and Parking Places) (Civil Enforcement and Consolidation) Order 2013.

3. The interpretation Act 1978 shall apply for the interpretation on this Order as it applies for the interpretation of an Act of Parliament
4. The Order will revoke The Flintshire County Council (Church Street, Flint) (Mandatory Cycle Lane) Order 2004 in its entirety.
5. In this Order, except where otherwise stated, any reference to a numbered Article or Schedule is a reference to the Article or Schedule bearing that number and any reference to a plan is reference to a plan incorporated in to this order.

SCHEDULE 1
No Waiting At Any Time
Flint

Road Name	Map Schedule	Sheet Revision
A548 Chester Street	AL58	4 (which revokes revision Sheet 3 from the 2013 Order)
	AL59	4 (which revokes revision Sheet 3 from the 2013 Order)
A548 Chester Road	AL58	4 (which revokes revision Sheet 3 from the 2013 Order)
	AL59	4 (which revokes revision Sheet 3 from the 2013 Order)
	AM59	2 (which revokes revision Sheet 1 from the 2013 Order)
A548 Trelawny Square	AL58	4 (which revokes revision Sheet 3 from the 2013 Order)
A548 Holywell Street	AL57	3 (which revokes revision Sheet 2 from the 2013 Order)
	AL58	4 (which revokes revision Sheet 3 from the 2013 Order)
Evans Street	AL57	3 (which revokes revision Sheet 2 from the 2013 Order)
Princes Street	AL58	4 (which revokes revision Sheet 3 from the 2013 Order)
Duke Street	AL58	4 (which revokes revision Sheet 3 from the 2013 Order)
Park Avenue	AL58	4 (which revokes revision Sheet 3 from the 2013 Order)
	AL59	4 (which revokes revision Sheet 3 from the 2013 Order)
Borough Grove	AM59	2 (which revokes revision Sheet 1 from the 2013 Order)

Trelawny Avenue	AM59	2 (which revokes revision Sheet 1 from the 2013 Order)
Market Square / Y	AL57	3 (which revokes revision Sheet 2 from the 2013 Order)
Farchnad	AL58	4 (which revokes revision Sheet 3 from the 2013 Order)
Queen Street	AL58	4 (which revokes revision Sheet 3 from the 2013 Order)
Church Street	AL58	4 (which revokes revision Sheet 3 from the 2013 Order)
Marsh Lane	AM57	1
Corporation Street	AL57	3 (which revokes revision Sheet 2 from the 2013 Order)
Earl Street	AK58	2 (which revokes revision Sheet 1 from the 2013 Order)
Salisbury Street	AL57	3 (which revokes revision Sheet 2 from the 2013 Order)
Castle Street	AL57	3 (which revokes revision Sheet 2 from the 2013 Order)
Lower Sydney Street	AL58	4 (which revokes revision Sheet 3 from the 2013 Order)
Lower Mumforth Street	AL58	4 (which revokes revision Sheet 3 from the 2013 Order)
Sydney Street	AL58	4 (which revokes revision Sheet 3 from the 2013 Order)
Castle Dyke Street	AL57 AM57	3 (which revokes revision Sheet 2 from the 2013 Order) 1
St Marys Walk	AL58	4 (which revokes revision Sheet 3 from the 2013 Order)
Barons Close	AL58	4 (which revokes revision Sheet 3 from the 2013 Order)
	AL59	4 (which revokes revision Sheet 3 from the 2013 Order)
At the junction of Numbers 55 - 57 Chester Road with the A548	AL58	4 (which revokes revision Sheet 3 from the 2013 Order)
At the entrance to the car park adjacent to Number 38 Chester Road.	AL59	4 (which revokes revision Sheet 3 from the 2013 Order)
At the junction of Number 31 Chester Road with the A548.	AM59	2 (which revokes revision Sheet 1 from the 2013 Order)
Service Road leading to Flint Retail Park Centre.(Including the mini roundabout)	AK58	2 (which revokes revision Sheet 1 from the 2013 Order)
Service Road leading to Flint Retail Park Centre junction with the Jade Jones Pavilion Centre Leisure Car parks.	AK58	2 (which revokes revision Sheet 1 from the 2013 Order)

Service Road junction adjacent to Number 28 and Number 34 Chester Street.	AL58	4 (which revokes revision Sheet 3 from the 2013 Order)
At the junction of Castle Dyke Street with the Lifeboat Station Car Park.	AM57	1

SCHEDULE 2
No Waiting 8am - 6pm
Flint

Road Name	Map Schedule	Sheet Revision
A548 Chester Road	AL58	4 (which revokes revision Sheet 3 from the 2013 Order)
	AL59	4 (which revokes revision Sheet 3 from the 2013 Order)
	AM59	2 (which revokes revision Sheet 1 from the 2013 Order)
Borough Grove	AL59	4 (which revokes revision Sheet 3 from the 2013 Order)
	AM59	2 (which revokes revision Sheet 1 from the 2013 Order)
Chapel Street.	AL58	4 (which revokes revision Sheet 3 from the 2013 Order)
	AL59	4 (which revokes revision Sheet 3 from the 2013 Order)
Service road at the rear of Numbers 2 – 28 Chester Street	AL58	4 (which revokes revision Sheet 3 from the 2013 Order)

SCHEDULE 3
Limited Waiting 8am - 6pm
30 minutes No Return within 1 Hour.
Flint

Road Name	Map Schedule	Sheet Revision
Church Street	AL58	4 (which revokes revision Sheet 3 from the 2013 Order)
Market Square / Y Farchnad	AL57	3 (which revokes revision Sheet 2 from the 2013 Order)
A548 Chester Street	AL58	4 (which revokes revision Sheet 3 from the 2013 Order)
Service Road fronting Numbers 6-28 Chester Street	AL58	4 (which revokes revision Sheet 3 from the 2013 Order)

THE COMMON SEAL of)
FLINTSHIRE COUNTY COUNCIL)
was hereunto affixed)
this 2nd day of June 2020)
in the presence of:-)



Marion Bateman

CHAIRMAN

LEGAL SERVICES MANAGER

AREA CODE: AK58
COD ARDAL: AK58



Sheet Revision No: 2
Rhif Adolgiad Y Ddalen: 2
Sheet active from: 29 June 2020
Dalen yn weithredol o: 29 Mehefin 2020



Scale: 1:1250
Graddfa: 1:1250

This map is reproduced from Ordnance Survey material with the permission of Ordnance Survey on behalf of the Controller of Her Majesty's Stationary Office ©Crown Copyright. Unauthorised reproduction infringes Crown Copyright and may lead to prosecution or civil proceedings. Licence No. 100023386

Atgynhyrchir y map hwn o ddeunydd yr Ordnance Survey gyda chaniatad yr Ordnance Survey ar ran Rheolwr Llyfrfa Ei Mawrhydi ©Hawlfraint y Goron. Mae atgynhyrchu heb ganiatad yn torri hawlfraint y Goron a gall hyn arwain at erlymiad neu achos sifil. Rhif trwydded 100023386

The Flintshire County Council
(Prohibition and Restriction of Waiting and Loading and Parking Places)
(Civil Enforcement and Consolidation) (Amendment No 39) Order 2020

Gorchymyn Cyngor Sir Y Fflint
(Gwahardd a Chyfyngu Aros a Llwytho a Mannau Parcio)
(Gorfodi Sifil a Chydgynferthu) (Gwelliant 39) 2020

Flintshire County Council
Environment Directorate
County Hall
Mold
CH7 6NF

Cyngor Sir Y Fflint
Cyfarwyddiaeth yr Amgylchedd
Neuadd Y Sir
Yr Wyddgrug
CH7 6NF

AREA CODE: AM59
COD ARDAL: AM59



Sheet Revision No: 2
Rhif Adolgiad Y Ddalen: 2
Sheet active from: 29 June 2020
Dalen yn weithredol o: 29 Mehefin 2020

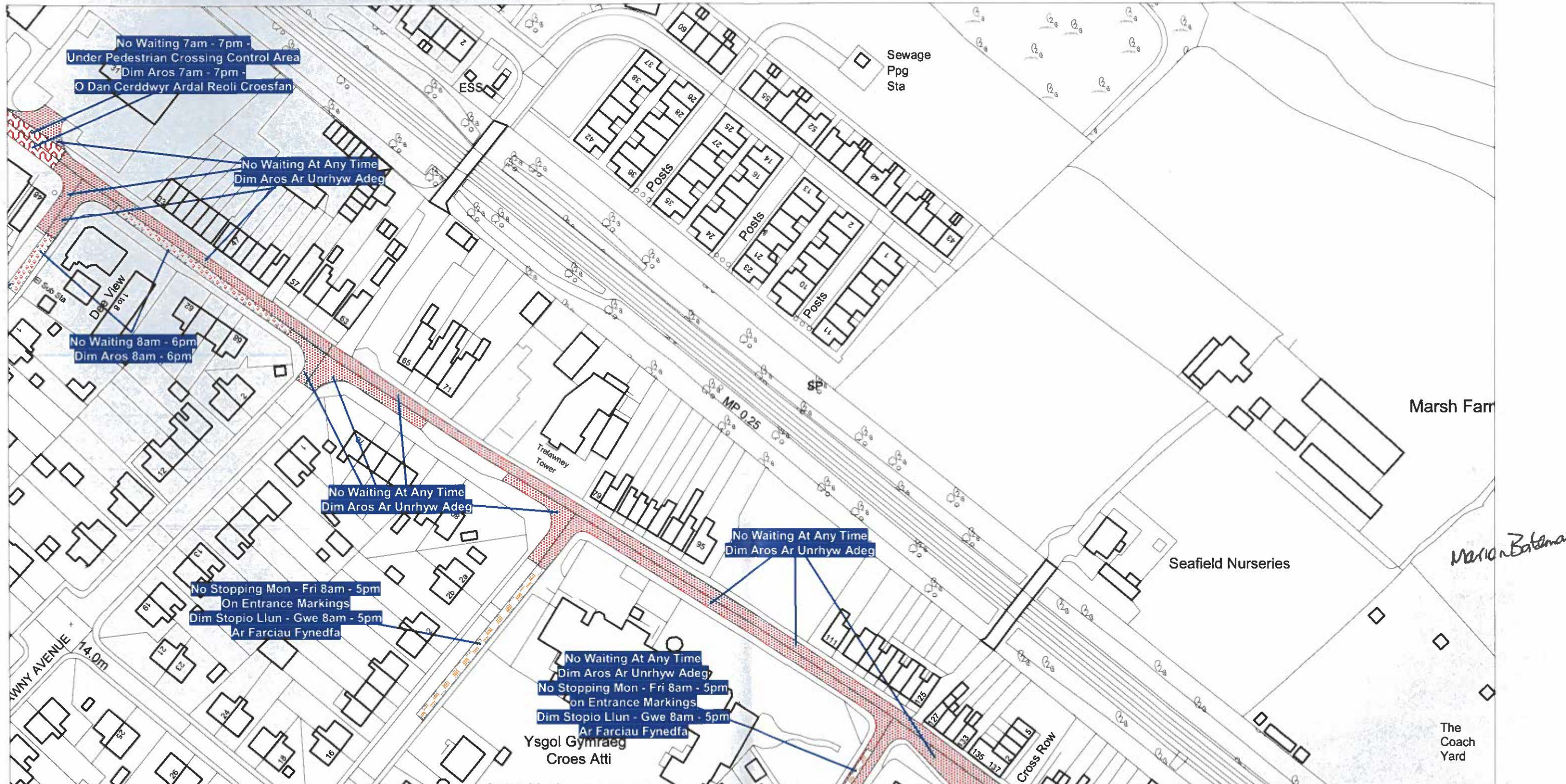

Scale: 1:1250
Graddfa: 1:1250

This map is reproduced from Ordnance Survey material with the permission of Ordnance Survey on behalf of the Controller of Her Majesty's Stationary Office ©Crown Copyright. Unauthorised reproduction infringes Crown Copyright and may lead to prosecution or civil proceedings. Licence No. 100023386

Atgynhyrchir y map hwn o ddeunydd yr Ordnance Survey gyda chaniatad yr Ordnance Survey ar ran Rheolwr Llyfrfa Ei Mawrhydi ©Hawlfraint y Goron. Mae atgynhyrchu heb ganiatad yn torri hawlfraint y Goron a gall hyn arwain at erlyniad neu achos sifil. Rhif trwydded 100023386

The Flintshire County Council
(Prohibition and Restriction of Waiting and Loading and Parking Places)
(Civil Enforcement and Consolidation) (Amendment No 39) Order 2020

Gorchymyn Cyngor Sir Y Fflint
(Gwahardd a Chyfyngu Aros a Llwytho a Mannau Parcio)
(Gorfodi Sifil a Chydygfynerthu) (Gwelliant 39) 2020

Flintshire County Council
Environment Directorate
County Hall
Mold
CH7 6NF

Cyngor Sir Y Fflint
Cyfarwyddiaeth yr Amgylchedd
Neuadd Y Sir
Yr Wyddgrug
CH7 6NF

AREA CODE: AL59
COD ARDAL: AL59



Sheet Revision No: 4
Rhif Adolgiad Y Ddalen: 4
Sheet active from: 29 June 2020
Dalen yn weithredol o: 29 Mehefin 2020

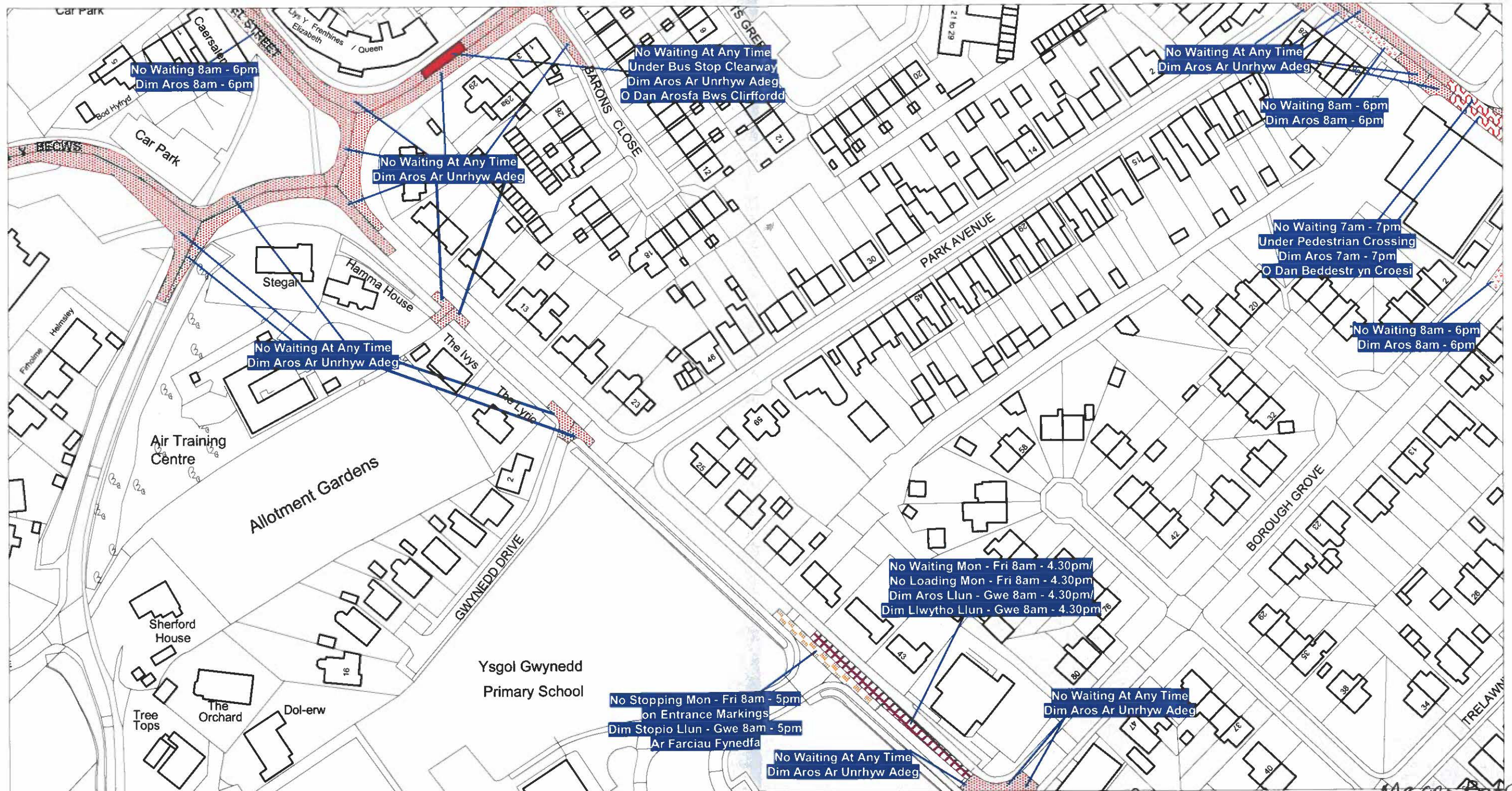

Scale: 1:1250
Graddfa: 1:1250

This map is reproduced from Ordnance Survey material with the permission of Ordnance Survey on behalf of the Controller of Her Majesty's Stationary Office ©Crown Copyright. Unauthorised reproduction infringes Crown Copyright and may lead to prosecution or civil proceedings. Licence No. 100023386

Atgynhyrchir y map hwn o ddeunydd yr Ordnance Survey gyda chaniatad yr Ordnance Survey ar ran Rheolwr Llyfrfa Ei Mawrhydi ©Hawlfraint y Goron. Mae atgynhyrchu heb ganiatad yn torri hawlfraint y Goron a gall hyn arwain at erlyniad neu achos sifil. Rhif trwydded 100023386

The Flintshire County Council
(Prohibition and Restriction of Waiting and Loading and Parking Places)
(Civil Enforcement and Consolidation) (Amendment No 39) Order 2020

Gorchymyn Cyngor Sir Y Fflint
(Gwahardd a Chyfyngu Aros a Llwytho a Mannau Parcio)
(Gorfodi Sifil a Chydygfynerthu) (Gwelliant 39) 2020

Flintshire County Council
Environment Directorate
County Hall
Mold
CH7 6NF

Cyngor Sir Y Fflint
Cyfarwyddiaeth yr Amgylchedd
Neuadd Y Sir
Yr Wyddgrug
CH7 6NF

AREA CODE: AL58
COD ARDAL: AL58



Sheet Revision No: 4
Rhif Adolgiad Y Ddalen: 4
Sheet active from: 29 June 2020
Dalen yn weithredol o: 29 Mehefin 2020

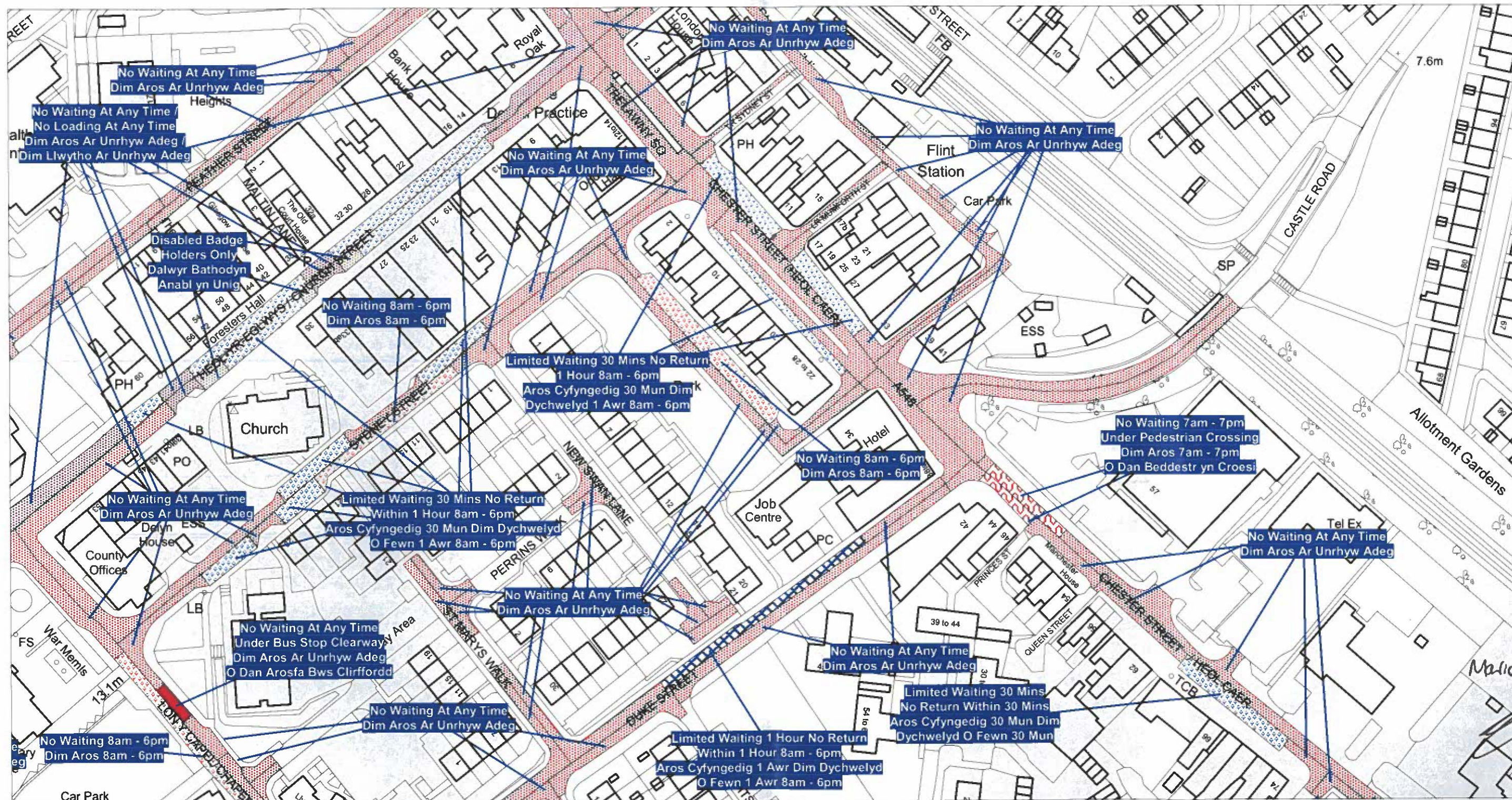

Scale: 1:1250
Graddfa: 1:1250

This map is reproduced from Ordnance Survey material with the permission of Ordnance Survey on behalf of the Controller of Her Majesty's Stationary Office ©Crown Copyright. Unauthorised reproduction infringes Crown Copyright and may lead to prosecution or civil proceedings. Licence No. 100023386

Atgynhychir y map hwn o ddeunydd yr Ordnance Survey gyda chaniatad yr Ordnance Survey ar ran Rheolwr Llyfrfa Ei Mawrhydi ©Hawffraint y Goron. Mae atgynhyrchu heb ganiatad yn torri hawffraint y Goron a gall hyn arwain at erlyniad neu achos sifil. Rhif trwydded 100023386

The Flintshire County Council
(Prohibition and Restriction of Waiting and Loading and Parking Places)
(Civil Enforcement and Consolidation) (Amendment No 39) Order 2020

Gorchymyn Cyngor Sir Y Fflint
(Gwahardd a Chyfyngu Aros a Llwytho a Mannau Parcio)
(Gorfodi Sifil a Chydgyfnerthu) (Gwelliant 39) 2020

Flintshire County Council
Environment Directorate
County Hall
Mold
CH7 6NF

Cyngor Sir Y Fflint
Cyfarwyddiaeth yr Amgylchedd
Neuadd Y Sir
Yr Wyddgrug
CH7 6NF

AREA CODE: AM57
COD ARDAL: AM57



Sheet Revision No: 1
Rhif Adolgiad Y Ddalen: 1
Sheet active from: 29 June 2020
Dalen yn weithredol o: 29 Mehefin 2020

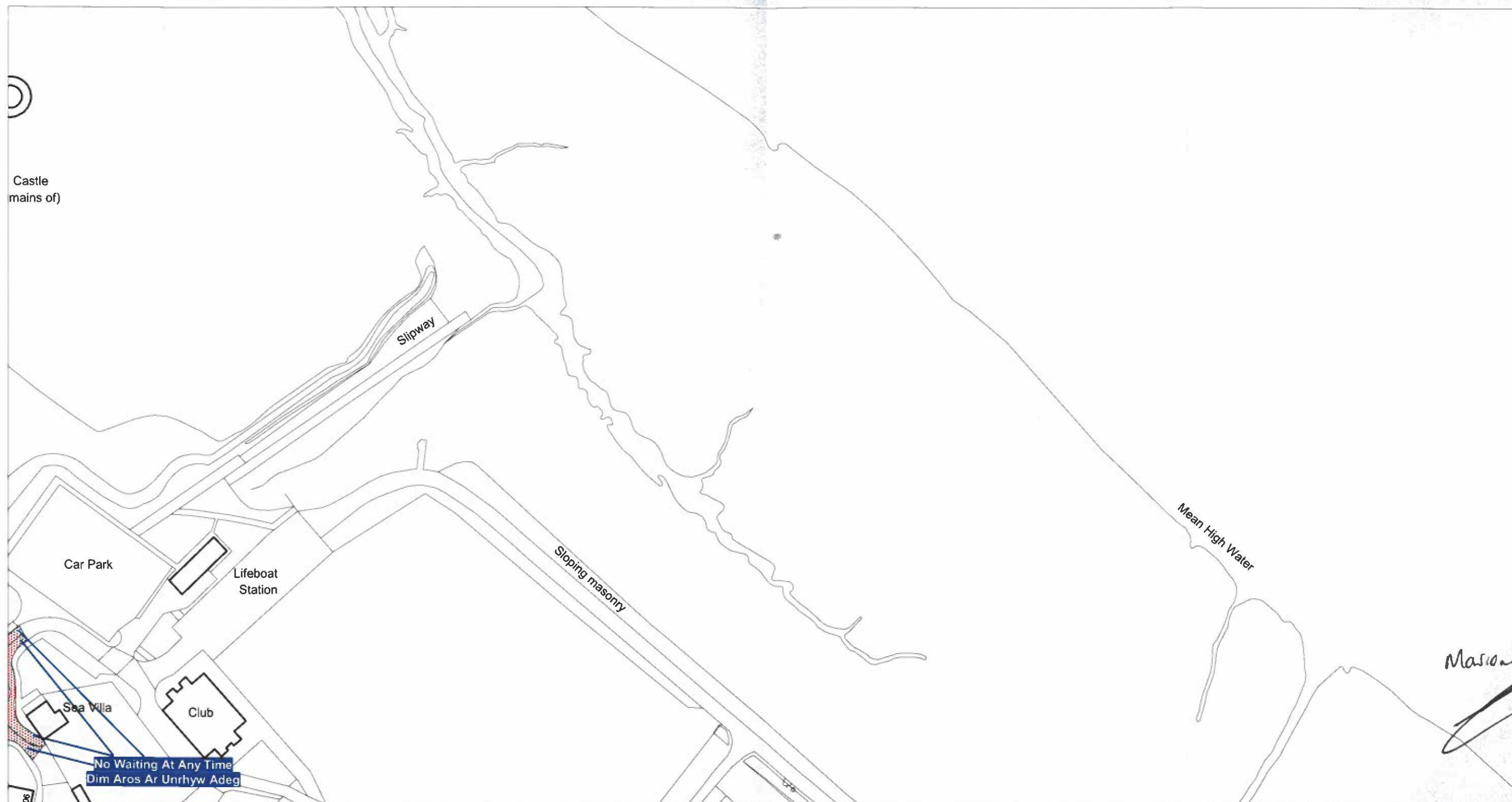

Scale: 1:1250
Graddfa: 1:1250

This map is reproduced from Ordnance Survey material with the permission of Ordnance Survey on behalf of the Controller of Her Majesty's Stationary Office ©Crown Copyright. Unauthorised reproduction infringes Crown Copyright and may lead to prosecution or civil proceedings. Licence No. 100023386

Atgynhyrchir y map hwn o ddeunydd yr Ordnance Survey gyda chaniatad yr Ordnance Survey ar ran Rheolwr Llyfrfa Ei Mawrhydi ©Hawlfraint y Goron. Mae atgynhyrchu heb ganiatad yn torri hawlfraint y Goron a gall hyn arwain at erlymiad neu achos sifil. Rhif trwydded 100023386

The Flintshire County Council
(Prohibition and Restriction of Waiting and Loading and Parking Places)
(Civil Enforcement and Consolidation) (Amendment No 39) Order 2020

Gorchymyn Cyngor Sir Y Fflint
(Gwahardd a Chyfyngu Aros a Llwytho a Mannau Parcio)
(Gorfodi Sifil a Chydgynferthu) (Gwelliant 39) 2020

Flintshire County Council
Environment Directorate
County Hall
Mold
CH7 6NF

Cyngor Sir Y Fflint
Cyfarwyddiaeth yr Amgylchedd
Neuadd Y Sir
Yr Wyddgrug
CH7 6NF

AREA CODE: AL57
COD ARDAL: AL57

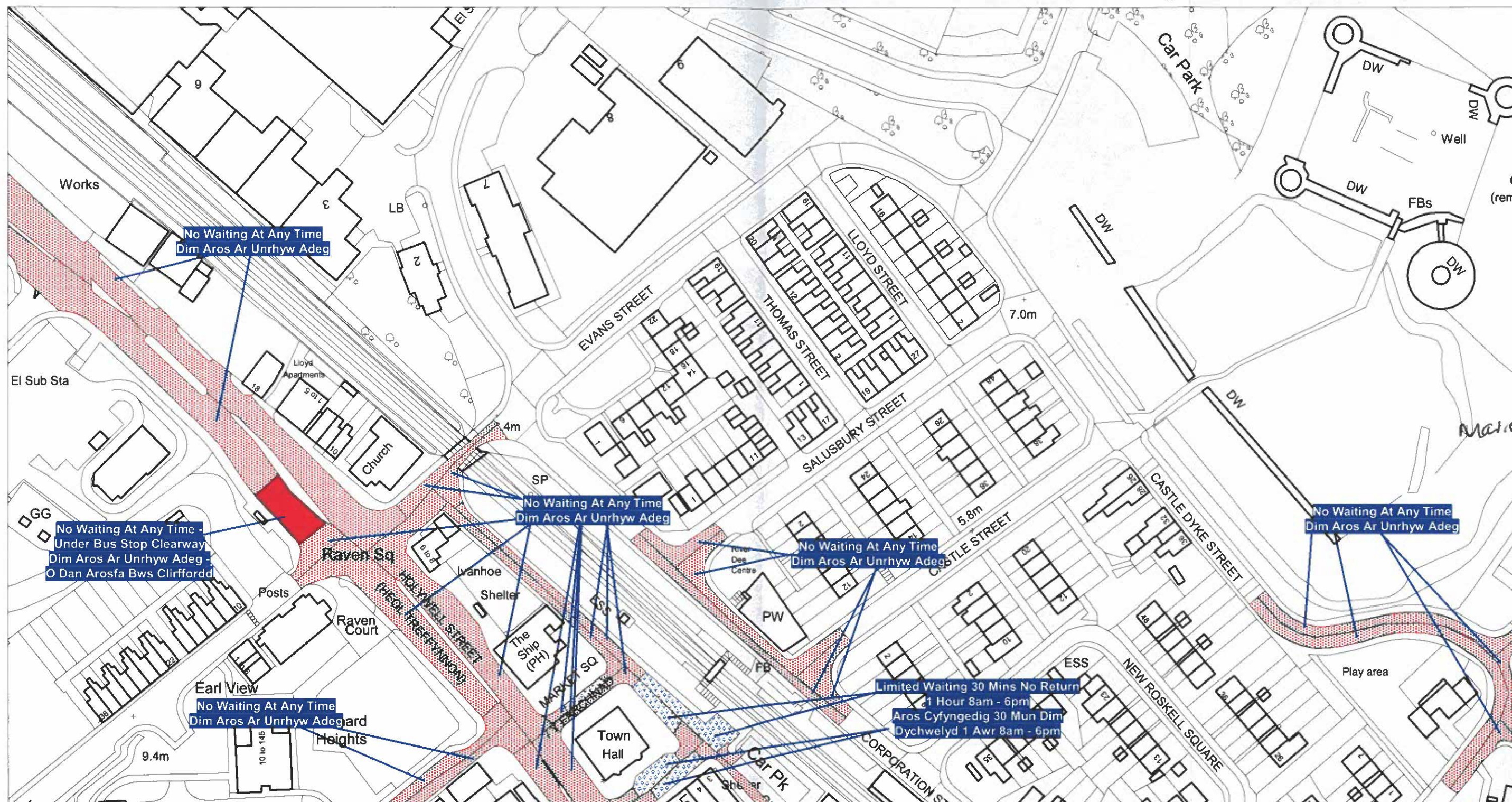

Scale: 1:1250
Graddfa: 1:1250

This map is reproduced from Ordnance Survey material with the permission of Ordnance Survey on behalf of the Controller of Her Majesty's Stationary Office ©Crown Copyright. Unauthorised reproduction infringes Crown Copyright and may lead to prosecution or civil proceedings. Licence No. 100023386

Atgynhyrchir y map hwn o ddeunydd yr Ordnance Survey gyda chaniatad yr Ordnance Survey ar ran Rheolwr Llyfrfa Ei Mawrhydi ©Hawlfraint y Goron. Mae atgynhyrchu heb ganiatad yn torri hawlfraint y Goron a gall hyn arwain at erlyniad neu achos sifil. Rhif trwydded 100023386

The Flintshire County Council
(Prohibition and Restriction of Waiting and Loading and Parking Places)
(Civil Enforcement and Consolidation) (Amendment No 39) Order 2020

Gorchymyn Cyngor Sir Y Fflint
(Gwahardd a Chyfyngu Aros a Llwytho a Mannau Parcio)
(Gorfodi Sifil a Chydgyfnerthu) (Gwelliant 39) 2020

Flintshire County Council
Environment Directorate
County Hall
Mold
CH7 6NF

Cyngor Sir Y Fflint
Cyfarwyddiaeth yr Amgylchedd
Neuadd Y Sir
Yr Wyddgrug
CH7 6NF

THE FLINTSHIRE COUNTY COUNCIL
(CHURCH STREET, FLINT)
(MANDATORY CYCLE LANE) ORDER 2004

The Flintshire County Council (hereinafter referred to as "the Council") in exercise of its powers under Sections 1(1) 2(1) and (2) of Part IV of Schedule 9 to the Road Traffic Regulation Act 1984 (which said Act of 1984 is hereinafter referred to as "the Act of 1984") and of all other enabling powers and after consultation with the Chief Officer of the Police in accordance with Part III of Schedule 9 to the Act of 1984 hereby Orders as follows:-

1. In this Order except where otherwise stated any reference in this Order to a numbered Article or Schedule is a reference to the Article or Schedule bearing that number in this Order.
2. In this Order:
 - (a) "cycle lane" means an area of the carriageway of the length of road specified in the Schedule to this Order and marked with the traffic signs shown in diagram 1049 in Schedule 6 to The Traffic Signs Regulations and General Directions 2002; and
 - (b) "pedal cycle" means a unicycle, bicycle, tricycle, or cycle having four or more wheels, not being in any case mechanically propelled unless it is an electrically assisted pedal cycle of such class as is to be treated as not being a motor vehicle for the purposes of the Act of 1984.
3. Except as provided in article 4, no person shall cause or permit any vehicle other than a pedal cycle to enter or proceed in the cycle lane at any time.
4. The controls specified in article 3 do not apply to:-
 - (a) a vehicle being used in connection with the maintenance, improvement or reconstruction of the highway in, or adjacent to, the cycle lane;
 - (b) a vehicle entering the cycle lane so as to avoid an accident;
 - (c) a vehicle entering the cycle lane to get or give help in consequence of an accident or an emergency or otherwise taking action for public safety;
 - (d) a vehicle entering and forthwith leaving the cycle lane in order to gain access to or egress from any vehicular access way to premises adjacent to the cycle lane or crossing over the footway adjacent to the cycle lane;
 - (e) anything done with the permission or at the direction of a police constable in uniform or a traffic warden.
5. The Interpretation Act 1978 shall apply for the interpretation of this Order as it applies for the interpretation of an Act of Parliament.

6. The Order shall come into operation on 20th September 2004 and may be cited as the Flintshire County Council (Church Street, Flint) (Mandatory Cycle Lane) Order 2004.

SCHEDULE

Cycle lane on north westerly side of Church Street from a point 11 metres east of the easterly kerb line of Chapel Street to a point 11 metres west of the westerly kerb line of A548 Holywell Road.

THE COMMON SEAL of FLINTSHIRE)
COUNTY COUNCIL was hereunto)
affixed the 14th day of September 2004)
in the presence of :-)

CHAIRMAN

H. W. Richards

[Signature]

ASSISTANT COUNTY SECRETARY



THE FLINTSHIRE COUNTY COUNCIL

A548 CHESTER STREET, A548 CHESTER ROAD, A548 HOLYWELL STREET, A548 TRELAWNY SQUARE, EVANS STREET, DUKE STREET, PARK AVENUE, CASTLE DYKE STREET, MARSH LANE, ST MARYS WALK, BARONS CLOSE, BOROUGH GROVE, TRELAWNY AVENUE, LOWER SYDNEY STREET, CHURCH STREET, EARL STREET, LOWER MUMFORTH STREET, CORPORATION STREET, SALUSBURY STREET, CASTLE STREET, SYDNEY STREET, FEATHER STREET, QUEEN STREET AND MARKET SQUARE / Y FARCHNAD FLINT.

PROPOSED PROHIBITION OF WAITING, PROHIBITION OF WAITING AT ANY TIME AND LIMITED WAITING.

Statement of Reasons for Proposing to make the Order

Flintshire County Council propose to introduce parking restrictions in the roads as listed above.

The Introduction of the No Waiting At Any Time restrictions, will improve safety for all road users through the removal of parked vehicles at key locations, whilst also improving traffic flow around Flint. It will also ensure access is maintained for residents, prevent obstruction, maintain visibility at the junctions and to ensure that the junctions are not obstructed by parked vehicles.

Parking at junctions, regardless of the presence of yellow lines, is an offence and the restrictions provide a visual deterrent to reinforce this message. At present, should vehicles be parked within 10 metres of a junction, an act of criminality may be committed and would therefore be subject to enforcement action by North Wales Police. Furthermore the Highway Code states that vehicles should not park near or on a junction as they may cause obstruction and compromise safety for all road users.

The introduction of on street parking, aims to improve the vibrancy and vitality of the town centre by providing a free short stay parking provision.

The County Council continues its responsibility to consider the provision of convenient and safe movement of motor vehicles and other traffic, and the proposed measures are aimed at ensuring that danger is minimised to vulnerable road users as well as improving the amenities of the locality.

The proposals are detailed in the Public Notice and in the proposed Order

Dated this 24th January 2020



Stephen O Jones,
Chief Officer (Streetscene & Transportation),
County Hall,
Mold,
Flintshire.
CH7 6NF