

The details shown on this drawing are confidential and the drawing is the exclusive property of Halliday Clark Limited. No use, copy or disclosure of the drawing may be made without our permission and it is to be returned to Halliday Clark Limited when required.
 Halliday Clark Limited take no responsibility for the use of this drawing for any purpose other than that for which it was intended. All dimensions are in millimeters unless stated otherwise. All dimensions should be verified on site prior to commencement of works.
 Do not scale from this drawing.
 All works must be in accordance with British Standards, EC Standards, Health & Safety at work act & all other relevant regulations & Bye Laws.
 Any discrepancies should be brought to the attention of Halliday Clark Limited.

Key

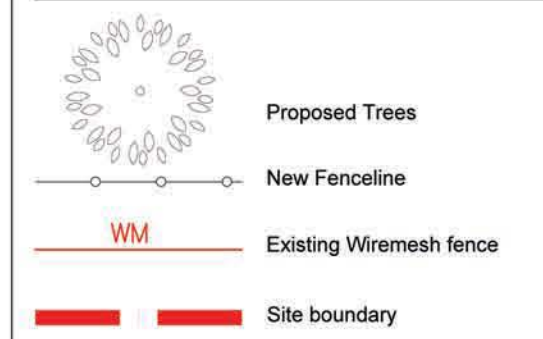

Schedule of Accommodation

| | |
|---------------------------------|-------------------|
| 2 no. 2B3P Apartment (Type 201) | 62.5sqm (672sqft) |
| 2 no. 2B3P Apartment (Type 202) | 67.3sqm (724sqft) |
| 1 no. 2B3P Apartment (Type 203) | 62.5sqm (672sqft) |
| 1 no. 2B3P Apartment (Type 204) | 70.0sqm (753sqft) |
| 2 no. 1B2P Apartment (Type 14) | 52.5sqm (565sqft) |
| 2 no. 1B2P Apartment (Type 15) | 55.2sqm (594sqft) |
| Total | 10 units |

Site Area 1517m² / 0.15Ha / 0.37acre



| | | |
|-----------------|------|---|
| G - 08.06.2018 | SJ | Revised apartment position, dotted line indicating old position. Existing vehicle access and drive indicated. Reversing dim added. |
| F - 08.06.2018 | GW | Topographical survey incorporated. Drawing revised to RIBA 3. Prepared for public consultation. |
| E - 17.08.2017 | SJ | Block moved over to retain hedge outside unit 9 & 10. Footpath and car parking altered as a result. Topographical survey introduced. |
| D - 06.06.2017 | SJ | Revised scheme in line with IS comments. |
| C - 02.06.2017 | SJ | Revised inline with Batch 3 review comments. Emergency vehicle denoted along with distance. Building mirrored and entry footpath moved as a result. Car parking area modified to allow more aspect distance for plots 1-6, distances denoted on drawing for clarity. Bedroom window moved due to overlooking aspect distance at units 8-10. |
| B - 17.05.2017 | SJ | revised following meeting with planners. |
| A - 14.05.2017 | SAE | Revised inline with FCC comments |
| - 21.02.2017 | MJS | INITIAL ISSUE |
| REVISION - DATE | DRWN | CHKD |

FOR APPROVAL

Fford Hiraethog
 Maes Pennant
 Mostyn
 CH8 9PE

FOR
 Wates Residential

Proposed Site Layout

Scale 1:200 @ A1

HALLIDAY CLARK
 ARCHITECTS

Halliday Clark Limited T 01943 604 123
 21 The Grove E info@hallidayclark.co.uk
 Ilkley LS29 9LW W hallidayclark.co.uk

Proposed Site Layout
 Scale 1:200
 0 2000 5000 10000 15000mm